

**DIN 934** similar to ISO 4032

## Hexagon nuts

External hex

Steel 8 | bright | Cr(VI)-free | Metric left-handed thread

Further information: DIN-standard has been withdrawn | changed spanner widths for M10, M12, M14 and M22 | the fine thread has been transferred to ISO 8673

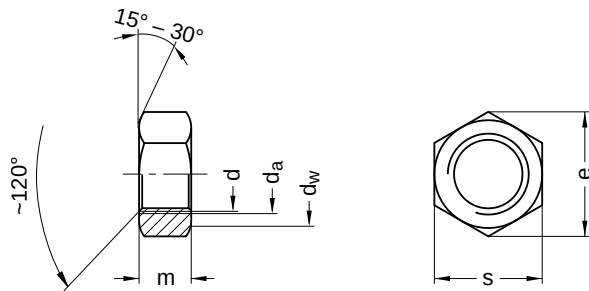

Diameter (d)	da		dw	e	m		s		Pitch (P)	Tool size
	min.	max.			min.	max.	min.	max.		
M5	5	5.75	6.8	8.79	3.70	4.0	7.78	8	0.80	SW 8
M6	6	6.75	8.8	11.05	4.70	5.0	9.78	10	1.00	SW 10
M8	8	8.75	11.3	14.38	6.14	6.5	12.73	13	1.25	SW 13
M10	10	10.80	15.3	18.90	7.64	8.0	16.73	17	1.50	SW 17
M12	12	13.00	17.2	21.10	9.64	10.0	18.67	19	1.75	SW 19
M16	16	17.30	22.2	26.75	12.30	13.0	23.67	24	2.00	SW 24
M30	30	32.40	42.7	50.65	22.70	24.0	45.00	46	3.50	SW 46

All technical data refer to the measure mm

