

DIN 934 similar to ISO 4032

Hexagon nuts

External hex

Steel 8 | hot-dip galvanised | Cr(VI)-free | Metric thread

Further information: DIN-standard has been withdrawn | changed spanner widths for M10, M12, M14 and M22 | the fine thread has been transferred to ISO 8673

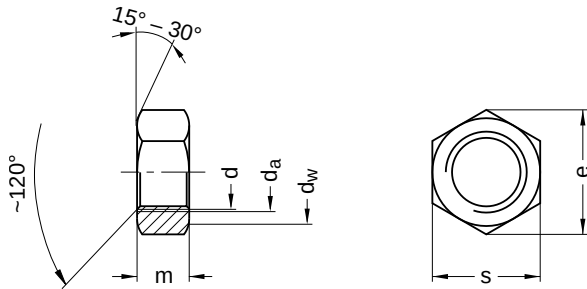

Diameter (d)	d _a		d _w	e	m		s		Pitch (P)	Tool size
	min.	max.			min.	max.	min.	max.		
M6	6	6.75	8.8	11.05	4.70	5.0	9.78	10	1.00	SW 10
M8	8	8.75	11.3	14.38	6.14	6.5	12.73	13	1.25	SW 13
M10	10	10.80	15.3	18.90	7.64	8.0	16.73	17	1.50	SW 17
M12	12	13.00	17.2	21.10	9.64	10.0	18.67	19	1.75	SW 19
M14	14	15.10	20.2	24.49	10.30	11.0	21.67	22	2.00	SW 22
M16	16	17.30	22.2	26.75	12.30	13.0	23.67	24	2.00	SW 24
M18	18	19.50	25.3	29.56	14.30	15.0	26.16	27	2.50	SW 27
M20	20	21.60	28.2	32.95	14.90	16.0	29.16	30	2.50	SW 30
M22	22	23.70	29.5	35.03	16.90	18.0	31.00	32	2.50	SW 32
M24	24	25.90	33.2	39.55	17.70	19.0	35.00	36	3.00	SW 36
M27	27	29.10	38.0	45.20	20.70	22.0	40.00	41	3.00	SW 41
M30	30	32.40	42.7	50.65	22.70	24.0	45.00	46	3.50	SW 46
M36	36	38.90	51.1	60.79	27.40	29.0	53.80	55	4.00	SW 55
M42	42	45.40	60.6	71.30	32.40	34.0	63.10	65	4.50	SW 65
M45	45	48.60	64.7	76.95	34.40	36.0	68.10	70	4.50	SW 70
M48	48	51.80	69.4	82.60	36.40	38.0	73.10	75	5.00	SW 75

All technical data refer to the measure mm

