

**ISO 7380-1**  
**Round head screws**

Hexagon socket

Stainless steel A2 | Cr(VI)-free | Metric thread

Further information: Due to their head geometry, these screws are limited in their load bearing capacity, see DIN EN ISO 898-1. Some dimensions thread up to head.

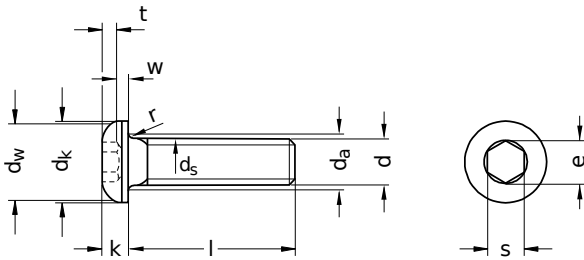

Diameter (d)	d <sub>a</sub> max.	d <sub>k</sub>		d <sub>s</sub>		d <sub>w</sub> min.	k		e min.	r min.	nominal size	s		Pitch (P)	t min.	w min.	Tool size
		min.	max.	min.	max.		min.	max.				min.	max.				
M3	3.6	5.40	5.7	2.86	3	5.00	1.40	1.65	2.30	0.10 0.30	2.0	2.02	2.08	0.50	1.04	0.20	SW 2
M4	4.7	7.24	7.6	3.82	4	6.84	1.95	2.20	2.87	0.20 0.40	2.5	2.52	2.58	0.70	1.30	0.30	SW 2,5
M5	5.7	9.14	9.5	4.82	5	8.74	2.50	2.75	3.44	0.20 0.45	3.0	3.02	3.08	0.80	1.56	0.38	SW 3
M6	6.8	10.07	10.5	5.82	6	9.57	3.00	3.30	4.58	0.25 0.50	4.0	4.02	4.10	1.00	2.08	0.74	SW 4
M8	9.2	13.57	14.0	7.78	8	13.07	4.10	4.40	5.72	0.40 0.70	5.0	5.02	5.14	1.25	2.60	1.05	SW 5
M10	11.2	17.07	17.5	9.78	10	16.57	5.20	5.50	6.86	0.40 0.70	6.0	6.02	6.14	1.50	3.12	1.45	SW 6
M12	13.7	20.48	21.0	11.73	12	19.68	6.24	6.00	9.15	0.60	8.0	8.02	8.18	1.75	4.16	1.63	SW 8

nominal size	Length (l)	
	min.	max.
6	7.71	8.29
8	7.71	8.29
10	9.71	10.29
12	11.65	12.35
14	13.65	14.35
16	15.65	16.35
18	-	-
20	19.58	20.42
22	21.58	22.42
25	24.58	25.42

nominal size	Length (l)	
	min.	max.
30	29.58	30.42
35	34.50	35.50
40	39.50	40.50
45	44.50	45.50
50	49.50	50.50
55	54.40	55.60
60	59.40	60.60
65	64.40	65.60
70	69.40	70.60

All technical data refer to the measure mm



**ISO 7380-1**

**Round head screws**

Hexagon socket

Stainless steel A2 | Cr(VI)-free | Metric thread

Diameter (d)	Length (l)																		
	6	8	10	12	14	16	18	20	22	25	30	35	40	45	50	55	60	65	70
M3	●	●	●	●	●	●		●		●	●								
M4	●	●	●	●		●		●		●	●	●	●						
M5	●	●	●	●		●		●		●	●	●	●	●	●				
M6		●	●	●	●	●	●	●	●	●	●	●	●	●	●	●	●	●	
M8			●	●		●		●		●	●	●	●	●	●	●	●	●	●
M10						●		●		●	●	●	●	●	●	●	●	●	●
M12																			●

• Combinations available in the eShop | Other sizes on request

All technical data refer to the measure mm

